

NEW



FE+ & FI+ **Connection Verification™**

- ✓ **Verify connections** are properly actuated **prior** to starting a leak test
- ✓ **Eliminate waste** caused by failed connections
- ✓ **Collect data** to verify operators have made the right connection
- ✓ **Automatically start leak tests** after the connection has been made
- ✓ **Improve safety** throughout the testing process



FE+ & FI+ Connection Verification

FE+ and FI+ Connection Verification™ quick connectors utilize an embedded, high-resolution sensor to signal when the connector has properly actuated. This unique technology provides greater connection accuracy and improves testing efficiency by reducing the number of failed tests due to improper or missed connections.

Why use Connection Verification?

- **Verify connections** are properly actuated **prior** to starting a leak test
- **Eliminate waste** caused by failed connections
- **Collect data** to verify operators have made the right connection
- **Automatically start leak tests** after the connection has been made
- **Improve safety** throughout the testing process

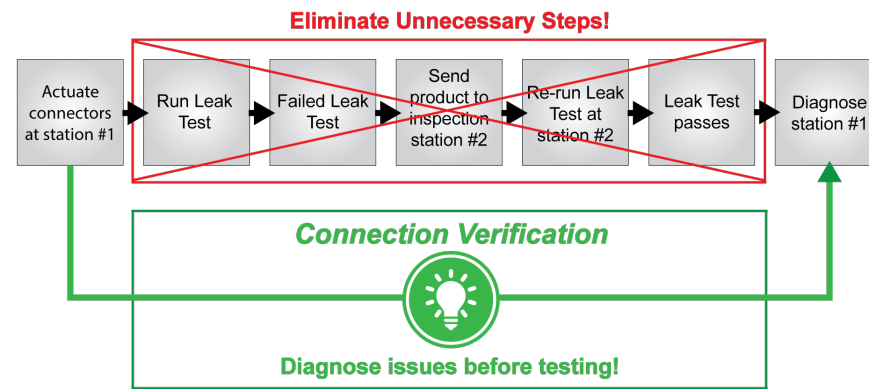

What is Connection Verification?

FE+ and FI+ Connection Verification™ quick connectors utilize an embedded, high-resolution sensor to signal when the connector has actuated according to pre-calibrated settings. Proper actuation is reliant on the consistency of four key attributes:

- Connector placement
- Pilot pressure
- Main seal diameter
- Product dimensions

▶ If one of these four attributes falls out of spec, **Connection Verification** will notify operators to check the system.

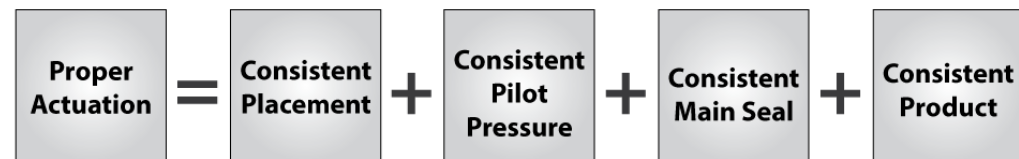
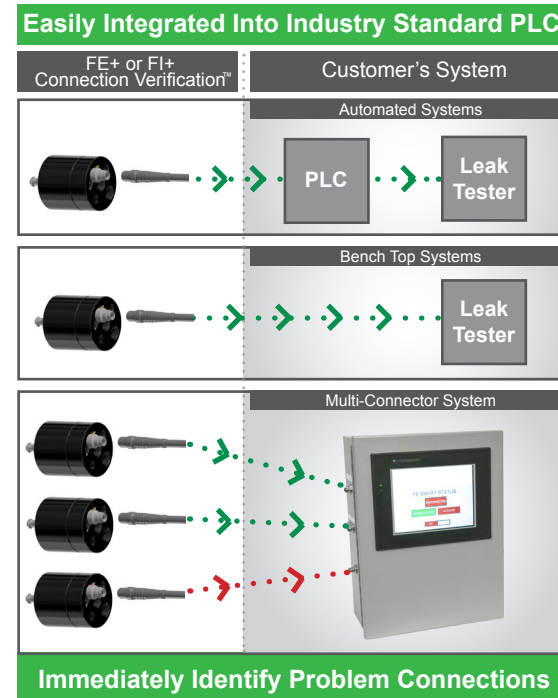

Connection Verification technology signals when there are changes to critical attributes in the testing environment



The Connection Verification System

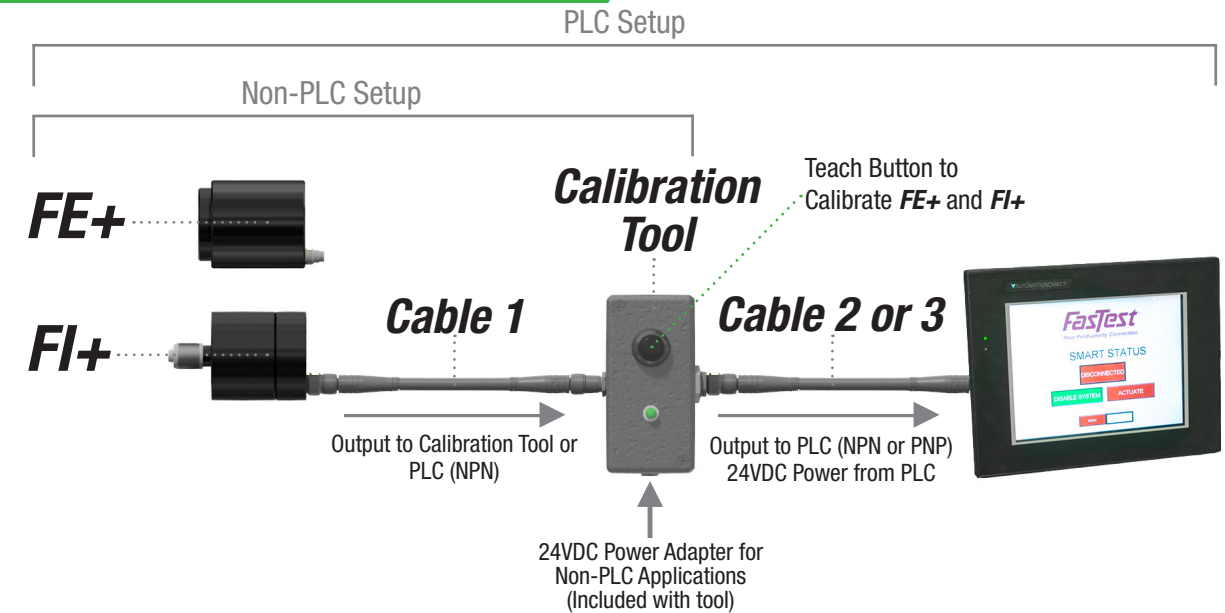

System Overview

The **Connection Verification** system provides a complete solution for a wide variety of applications. Utilize the Calibration Tool in non-PLC systems to reduce setup time.

Calibration Tool

- Quickly set calibration points on the **FE+** or **FI+** connectors
- Eliminate the need for PLC programming
- LED connection status visual feedback
- NPN or PNP options

Part Number	Description	Sealing Range	Seal Sets	Output Signal
Internal (FI) Quick Connectors				
FI01-CV02	Base FI01 connector with Connection Verification, M8 termination	0.310"-0.394"	Sold separately	NPN
FI1-CV02	Base FI1 connector with Connection Verification, M8 termination	0.394"-0.630"	Sold separately	NPN
FI2-CV02	Base FI2 connector with Connection Verification, M8 termination	0.630"-0.866"	Sold separately	NPN
FI3-CV02	Base FI3 connector with Connection Verification, M8 termination	0.866"-1.102"	Sold separately	NPN
FI4-CV02	Base FI4 connector with Connection Verification, M8 termination	1.102"-1.339"	Sold separately	NPN
FI5-CV02	Base FI5 connector with Connection Verification, M8 termination	1.339"-1.693"	Sold separately	NPN
FI6-CV02	Base FI6 connector with Connection Verification, M8 termination	1.693"-2.165"	Sold separately	NPN
FI7-CV02	Base FI7 connector with Connection Verification, M8 termination	2.165"-2.585"	Sold separately	NPN
FI8-CV02	Base FI8 connector with Connection Verification, M8 termination	2.585"-3.005"	Sold separately	NPN
External (FE) Quick Connectors				
FE01-CV02	Base FE01 connector with Connection Verification, M8 termination	0.310"-0.394"	Sold separately	NPN
FE1-CV02	Base FE1 connector with Connection Verification, M8 termination	0.394"-0.630"	Sold separately	NPN
FE2-CV02	Base FE2 connector with Connection Verification, M8 termination	0.630"-0.866"	Sold separately	NPN
FE3-CV02	Base FE3 connector with Connection Verification, M8 termination	0.866"-1.102"	Sold separately	NPN
FE4-CV02	Base FE4 connector with Connection Verification, M8 termination	1.102"-1.339"	Sold separately	NPN
FE5-CV02	Base FE5 connector with Connection Verification, M8 termination	1.339"-1.693"	Sold separately	NPN
FE6-CV02	Base FE6 connector with Connection Verification, M8 termination	1.693"-2.165"	Sold separately	NPN
Calibration System				
SPCT-0101P	Calibration tool for CV02 enabled connectors (sourcing)			PNP
SPCT-0101N	Calibration tool for CV02 enabled connectors (sinking)			NPN
SPCASR0402APP	Cable 1 (M8 to M8), 2m length			N/A
SPCASR0502C	Cable 2 (M8 to flying lead), 2m length			N/A
TSE00035	Cable 3 (M8 to M12), 2m length			N/A

Where to Buy



Purchase through local distributor

- ▶ Factory authorized distributors provide local service and support across the U.S.A. and internationally.
- ▶ Contact your local distributor or visit: www.fastestinc.com/en/distributorlocator

Cost, Process and Quality Improvement

Since 1985, **FasTest, Inc.** has manufactured quick test connectors and valves that maximize efficiency, productivity and profitability for the Industrial Manufacturing, HVAC-R and Compressed Gas Industries.

Relying on our core engineering skills, FasTest has secured over 50 US and International patents. These patents serve as the design platform for innovative products that enable our customers to improve testing, manufacturing processes and productivity.

Proudly Serving



JOHN DEERE



KOHLER®

NAVISTAR®



FasTest®

Headquarters in USA

1646 Terrace Drive • Roseville, MN 55113-1317

Phone: +1.651.645.6266

Fax: +1.651.645.7390

www.fastestinc.com

Proudly Manufactured in the U.S.A.

Notifications and Copyright

Specifications in this brochure are subject to change without notice. FasTest also reserves the right to make modifications and makes no guarantee of the accuracy of the information contained herein.

FasTest is a registered trademark with the US Patent & Trademark Office.

© 2017 FasTest Inc. All rights reserved.

No part of this publication may be reproduced without written permission.

Patents

FasTest Inc. takes pride in its innovative quick disconnect coupling solutions, many of which have been awarded United States and International patents. FasTest Inc. has a strong tradition of leadership in the quick disconnect market, and aggressively pursues and protects its proprietary information and intellectual property.

All products are designed and manufactured by Fastest Inc. USA

Limited Express Warranty

FasTest Inc. warrants its products against defects in workmanship and materials for 12 months from the date of sale by FasTest Inc. or its authorized distributor. This warranty is void if the product is misused, tampered with or used in a manner that is contrary to FasTest Inc.'s written recommendations and/or instructions.

See website for complete warranty information.

Custom Applications

FasTest has full engineering and manufacturing capability to provide special accommodations to meet specific applications. Our engineers are available to review your unique application requirements.

Certifications

FasTest Inc. is ISO 9001: 2008 certified.